

200+ Patent Certificates
\$1,000,000+ Annual Energy Saving
20,000+ Projects Successfully Installed



SAB All in One Solar Street Light

Power: 30W - 300W



Innovative & Tailored
Lighting Solutions for **Success**
www.aokledlight.com

Discover **SAB** Series

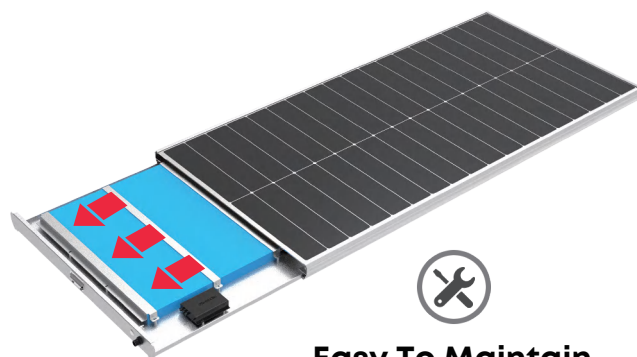
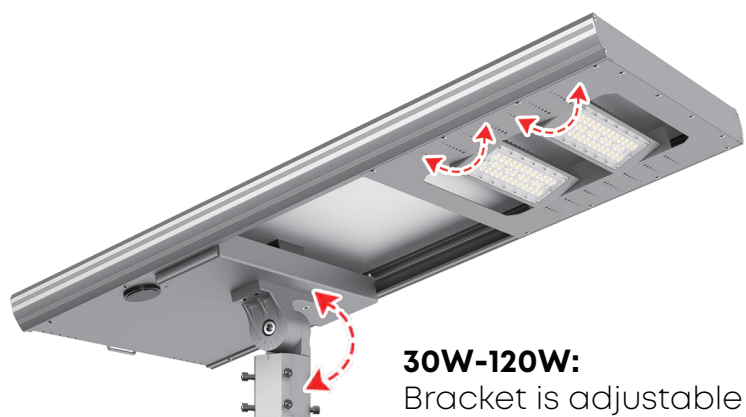

WARRANTY

3 Year Limited Warranty,
5 Year Preferred Warranty.
Please consult with our sales for detailed agreement.

- Charging time: 6.7 hours to 8.1 hours (standard).
- External power switch, optional external charging interface (requires additional configuration).
- Built-in/external grid complementary power supply.
- Lighting options: T203, T212 (T2M), T304, T402, T502;
- The controller uses IP67 waterproof connectors for easy assembly and disassembly. IP65 waterproof switch ensures minimal energy consumption during transportation.

Advantages of SAB All in One Solar Street Light



**Adjustable &
Reinforced Bracket**



**Monocrystalline
Silicon Solar Panel**



**Long Lifespan
Li-ion Battery & MPPT**



**Aviation Aluminum
Profile Frame**



**Strong Corrosion
Resistance**



**Intelligent Lighting
Control**

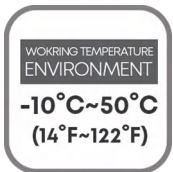

wally@aokledlight.com
+1 626-986-4050 (US)
+86 755 2357 9148 (CN)

©2025 AOK Industrial Company Limited. All Right Reserved.



Key Components



LiFePO4 Battery

Uses LiFePO4 batteries, enduring over 2000 charge/discharge cycles for safety, compactness, and longer lifespan.



Remote Control

The lighting program can be easily modified to save more energy and extend working time during low sunlight, thereby prolonging battery life.



MPPT Charge Controller

All street lights use the MPPT solar controller, boosting charging efficiency by 30% compared to PWM and ensuring more stable performance.

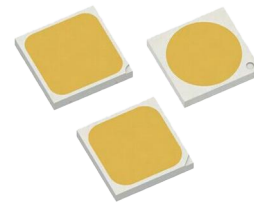

TYF LED Chips

It uses ultra-high brightness TYF LED chips to provide the best lighting performance with minimal power consumption.



Optics Lens

The distributions design focused on the road's center, reducing light pollutions. Various lens patterns are available to meet different project needs.

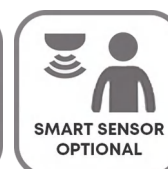

Energy-efficient Lighting Systems

Single lumen efficiency **>200lm/W**
achieve higher illumination

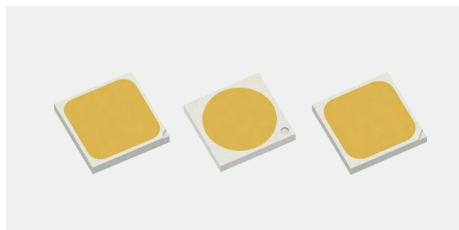

High Efficiency



Long Lifespan



Less Calorific Value



Low Light Decay

- Aerospace aluminum profile frame, strong corrosion resistance, lightweight;
- Akzo powder neutral salt spray corrosion for 1000 hours;
- Featuring the 5050 LED chip, it serves as a top-tier light source up to 200lm/W;
- The well-optimized light distribution ensures a more uniform illuminated area, minimizing upper light pollution;

Multiple Distribution Options

General solution, accurate light distribution design, flexible to match the project requirements:

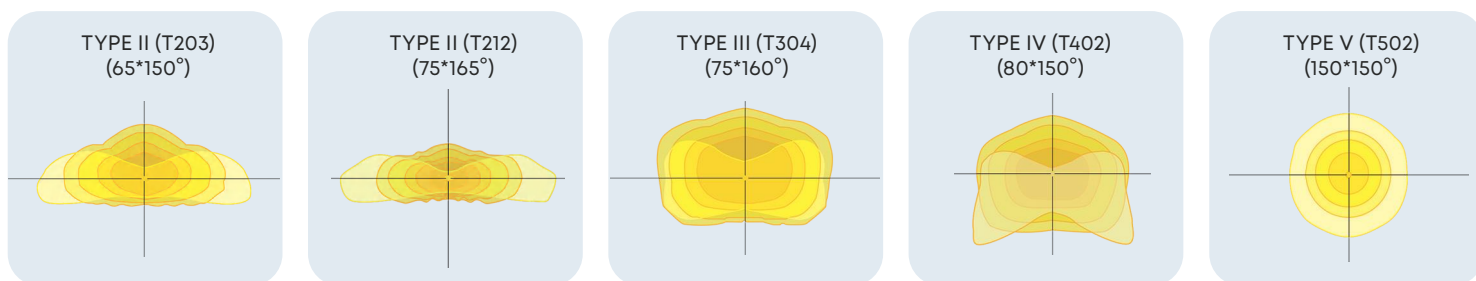

* Due to working temperature and CCT/CRI adjustments, actual photometric values may vary slightly. Please consult the measured IES file for accurate data. The above information is for reference purposes only.

Smart Control Ready For Efficient Management

Application of **Typical Networking** of Smart Street Light (optional)



Single lamp control

Control street light switch, brightness adjustment, current acquisition. Voltage acquisition, power calculation and power factor functions.



Wireless network

From the device to the cloud, NB-IoT, GPRS, LTE and other cellular networks are used, without cabling.



Fault management

The street light can automatically report fault information, troubleshoot faults through the platform, and query historical faults.



Energy management

Supports online monitoring and storage of energy consumption and configuring energy saving policies.



Intelligent monitoring

Support remote monitoring and remote control through PC web and mobile APP.



Big data analysis

Based on the massive data of the platform, street light fault analysis and energy consumption analysis can be carried out to provide a basis for the maintenance of street light equipment to save energy and reduce consumption.

Application of Typical IOT networking

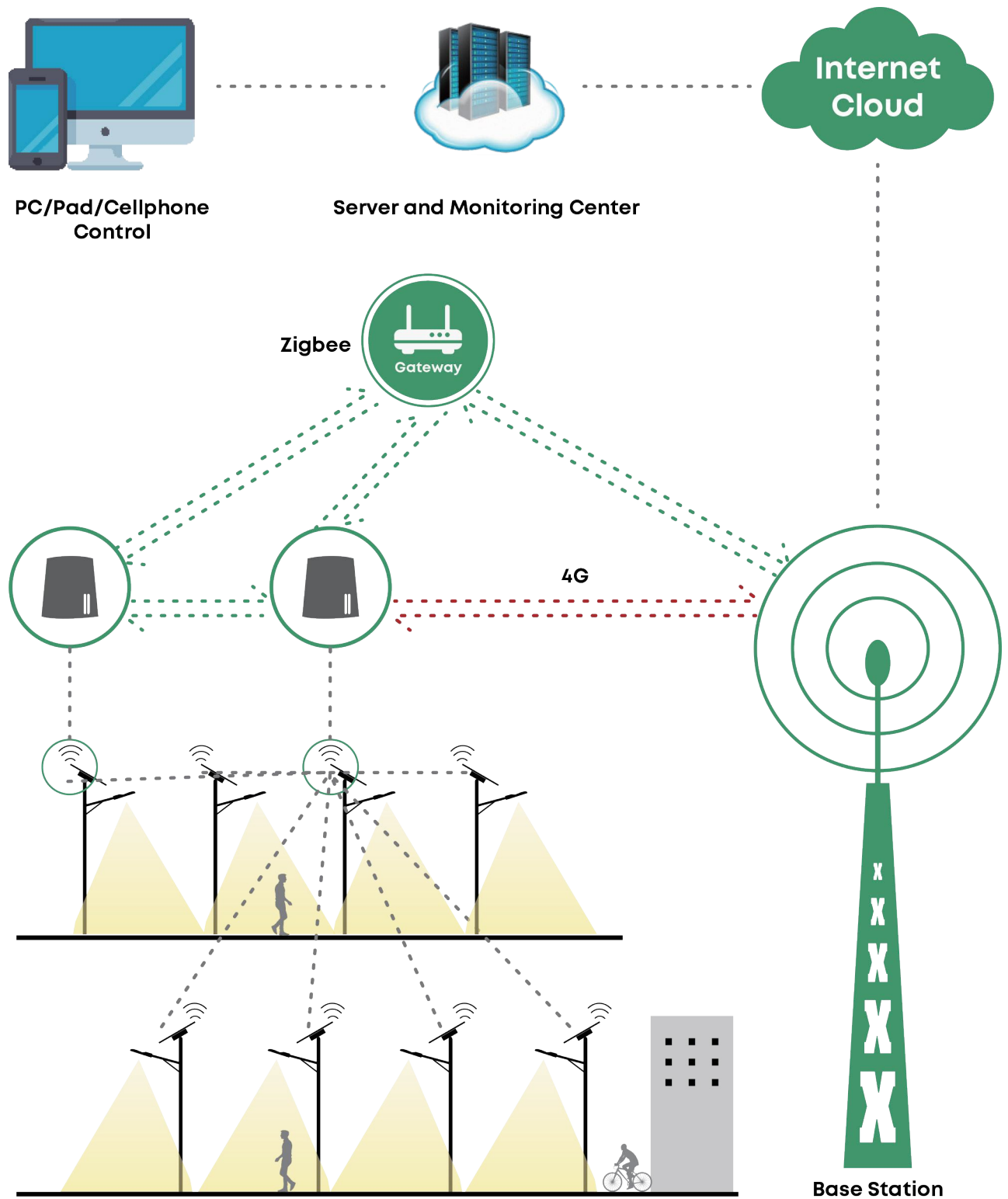

Application Reference

- Road & street lighting
- Residential area lighting
- Garden, parks & perimeter lighting
- Parking lot lighting
- Industrial and commercial park lighting
- Railway & station side lighting
- Riverside & jogging track lighting



Parameter Table

Electrical Data						
Model	AOK-30WSAB		AOK-40WSAB	AOK-50WSAB	AOK-60WSAB	AOK-80WSAB
Power	30W		40W	50W	60W	80W
Control Option	Photocell sensor, Timing, dimming, intelligent power saving, microwave sensor or PIR sensor.					
Grid Hybrid power Solution(optional) Driver			Inventronics/Meanwell			
Work Mode	4H-Detected 100%, None 30% ;3H-Detected 70%, None 30% ;3H-Detected 50%, None 20%; 4H-Detected 30%, None 10%					
Photometric Data						
LED Model		5050, custom on request				
Lens		Polycarbonate				
Efficacy (lm/W, Std. Dev. ±5%)@CCT=5700K, CRI>70Ra	5050	200lm/W	200lm/W	200lm/W	200lm/W	200lm/W
Luminous Flux (lm, Std. Dev. ±5%)@CCT=5700K, CRI>70Ra	5050	6000lm	8000lm	10000lm	12000lm	16000lm
ULOR		= 0%, @ Luminaire inclination 0°				
CCT		3000K~6500K				
CRI		70Ra/80Ra optional				
Beam Angle		T203(65°*150°) / T212(75°*165°) / T304(75°*160°) / T402(80°*150°) / T502(150°*150°)				
Mechanical Data						
SCx (EPA)	Top View: 0.237m² (2.55ft²) Side View: 0.057m² (0.614ft²) Front View: 0.047m² (0.506ft²)	Top View: 0.335m² (3.61ft²) Side View: 0.074m² (0.797ft²) Front View: 0.047m² (0.506ft²)	Top View: 0.399m² (4.29ft²) Side View: 0.084m² (0.904ft²) Front View: 0.047m² (0.506ft²)	Top View: 0.442m² (4.76ft²) Side View: 0.091m² (0.98ft²) Front View: 0.047m² (0.506ft²)	Top View: 0.576m² (6.2ft²) Side View: 0.085m² (0.915ft²) Front View: 0.06m² (0.646ft²)	
IP Rating	IP65					
Housing	Alluminum+SPCC					
Surface Treatment	Anti-UV thermosetting polyester / 80 micron epoxy primer + Anti-UV thermosetting polyester (for extremely corrosive environments).					
Painting	Gray, custom color on request.					
Mounting	Post Top					
Configuration Data						
Photovoltaic Panel		Single side monocrystalline solar panel				
Solar Panel Voltage(W)	18V 40W	18V 60W	18V 70W	18V 80W	18V 100W	
Battery Voltage(AH)	12.8V 15AH	12.8V 30AH	12.8V 30AH	12.8V 45AH	12.8V 45AH	
Li-ion Battery(WH)	192WH	384WH	384WH	576WH	576WH	
Charging Time	5.1Hrs	6.7Hrs	5.8Hrs	7.6Hrs	6.1Hrs	
Run Time (@full power)	6.1Hrs	9.1Hrs	7.3Hrs	9.1Hrs	6.8Hrs	
Battery Lifespan		>2000 times cycle				
Ambient Temperature		-10°C to 50°C (14°F to 122°F)				
Storage Temperature		-20°C to 45°C (-4°F to 113°F)				
Control System		MPPT/PWM optional, custom IOT or remote control on request				
Maximum Autonomy		Operate 2~3 rainy days under intelligent model.				
Others						
Lifespan		L90B10 - 100000 hrs, @Tq 25°C				
Warranty		3 years as standard (Warranty extension to 5 years on request)				
Certification		Please consult for certification				
Product Size	625*378*62 mm 24.6*14.9*2.4 in	885*378*62 mm 34.8*14.9*2.4 in	1055*378*62 mm 41.5*14.9*2.4 in	1170*378*62 mm 46.1*14.9*2.4 in	1061*543*62 mm 41.8*21.4*2.4 in	
Carton Size	855*435*140 mm 33.7*17.1*5.5 in	1112*435*140 mm 43.8*17.1*5.5 in	1290*435*140 mm 50.8*17.1*5.5 in	1395*435*140 mm 54.9*17.1*5.5 in	1305*620*140 mm 51.4*24.4*5.5 in	
Net Weight	11.1 kg / 24.5 lbs	14.4 kg / 31.7 lbs	15.4 kg / 34 lbs	17.8 kg / 39.2 lbs	20.2 kg / 44.5 lbs	
Gross Weight	12 kg / 26.5 lbs	15.3 kg / 33.7 lbs	16.6 kg / 36.6 lbs	19 kg / 41.9 lbs	21.9 kg / 48.3 lbs	
Recommend Installation Height	4-7m	5-7m	5-7m	6-8m	7-9m	
Application Field		Road & street, residential area, garden, parks, parking lot, industrial and commercial parks, railway & station side, riverside & jogging track				
Storage Instruction		For long-term storage, it is advisable to charge 30% for the battery, then discharge it for 2 to 3 hours. This should be done every 3 months to prevent battery damage and extend the battery lifespan.				
Important Note!		The provided information is solely for reference; the official measurement report holds higher authority.				

Parameter Table

Electrical Data						
Model	AOK-100WSAB		AOK-120WSAB	AOK-150WSAB	AOK-200WSAB	AOK-300WSAB
Power	100W		120W	150W	200W	300W
Control Option	Photocell sensor, Timing, dimming, intelligent power saving, microwave sensor or PIR sensor.					
Grid Hybrid power Solution(optional) Driver			Inventronics/Meanwell			
Work Mode	4H-Detected 100%, None 30% ;3H-Detected 70%, None 30% ;3H-Detected 50%, None 20%; 4H-Detected 30%, None 10%					
Photometric Data						
LED Model			5050, custom on request			
Lens		Polycarbonate				
Efficacy (lm/W, Std. Dev. ±5%)@CCT=5700K, CRI>70Ra	5050	200lm/W	200lm/W	200lm/W	200lm/W	200lm/W
Luminous Flux (lm, Std. Dev. ±5%)@CCT=5700K, CRI>70Ra	5050	20000lm	24000lm	30000lm	40000lm	60000lm
ULOR			= 0%, @ Luminaire inclination 0°			
CCT		3000K~6500K				
CRI			70Ra/80Ra optional			
Beam Angle			T203(65°*150°) / T212(75°*165°) / T304(75°*160°) / T402(80°*150°) / T502(150°*150°)			
Mechanical Data						
SCx (EPA)	Top View: 0.622m² (6.7ft²) Side View: 0.09m² (0.969ft²) Front View: 0.06m² (0.646ft²)		Top View: 0.755m² (8.13ft²) Side View: 0.107m² (1.15ft²) Front View: 0.06m² (0.646ft²)	Top View: 1.33m² (14.32ft²) Side View: 0.113m² (1.22ft²) Front View: 0.078m² (0.84ft²)	Top View: 1.258m² (13.54ft²) Side View: 0.123m² (1.32ft²) Front View: 0.078m² (0.84ft²)	Top View: 1.787m² (19.24ft²) Side View: 0.139m² (1.5ft²) Front View: 0.097m² (1.04ft²)
IP Rating	IP65					
Housing	Alluminum+SPCC					
Surface Treatment	Anti-UV thermosetting polyester / 80 micron epoxy primer + Anti-UV thermosetting polyester (for extremely corrosive environments).					
Painting	Gray, custom color on request.					
Mounting	Post Top					
Configuration Data						
Photovoltaic Panel			Single side monocrystalline solar panel			
Solar Panel Voltage(W)	36V 120W		36V 150W	36V 200W	36V 240W	36V 360W
Battery Voltage(AH)	25.6V 30AH		25.6V 45AH	25.6V 45AH	25.6V 60AH	25.6V 90AH
Li-ion Battery(WH)	768WH		1152WH	1152WH	1536WH	2304WH
Charging Time	6.7Hrs		8.1Hrs	6.1Hrs	6.7Hrs	6.7Hrs
Run Time (@full power)	7.3Hrs		9.1Hrs	7.3Hrs	7.3Hrs	7.3Hrs
Battery Lifespan			>2000 times cycle			
Ambient Temperature	-10°C to 50°C (14°F to 122°F)					
Storage Temperature	-20°C to 45°C (-4°F to 113°F)					
Control System	MPPT/PWM optional, custom IOT or remote control on request					
Maximum Autonomy	Operate 2~3 rainy days under intelligent model.					
Others						
Lifespan			L90B10 - 100000 hrs, @Tq 25°C			
Warranty	3 years as standard (Warranty extension to 5 years on request)					
Certification			Please consult for certification			
Product Size	1146*543*62 mm 45.1*21.4*2.4 in		1392*543*62 mm 54.8*21.4*2.4 in	1456*778*62 mm 57.3*30.6*2.4 in	1616*778*62 mm 63.6*30.6*2.4 in	1846*968*62 mm 72.7*38.1*2.4 in
Carton Size	1390*620*140 mm 54.7*24.4*5.5 in		1635*615*140 mm 64.4*24.2*5.5 in	1702*855*195 mm 67*33.7*7.7 in	1862*855*195 mm 73.3*33.7*7.7 in	2115*1045*195 mm 83.3*41.1*7.7 in
Net Weight	22.7 kg / 50 lbs		27.3 kg / 60.2 lbs	36.9 kg / 81.4 lbs	41.7 kg / 91.9 lbs	62.9 kg / 138.7 lbs
Gross Weight	24.4 kg / 53.8 lbs		29.2 kg / 64.4 lbs	40.3 kg / 88.8 lbs	45.4 kg / 100.1 lbs	67.4 kg / 148.6 lbs
Recommend Installation Height	8-10m		8-12m	10-12m	10-12m	10-12m
Application Field	Road & street, residential area, garden, parks, parking lot, industrial and commercial parks, railway & station side, riverside & jogging track					
Storage Instruction	For long-term storage, it is advisable to charge 30% for the battery, then discharge it for 2 to 3 hours. This should be done every 3 months to prevent battery damage and extend the battery lifespan.					
Important Note!	The provided information is solely for reference; the official measurement report holds higher authority.					

Ordering Information

AOK						
MODEL	LED CHIPS	TYPE OF SENSOR	CCT&CRI	DISTRIBUTION	MOUNT	HOUSING
30WSAB	A5=5050	00=Without Sensor	3070=3000K 70CRI	T203 (65°*150°)	A=Post Top	GR=Gray
40WSAB		PIR=PIR Sensor	4070=4000K 70CRI	T212 (75°*165°)		BK=Black
50WSAB		MS=Microwave Sensor	5070=5000K 70CRI	T304 (75°*160°)		SI=Silver
60WSAB			5770=5700K 70CRI	T402 (80°*150°)		Custom request
80WSAB			6570=6500K 70CRI	T502 (150°*150°)		
100WSAB			3080=3000K 80CRI			
120WSAB			4080=4000K 80CRI			
150WSAB			5080=5000K 80CRI			
200WSAB			5780=5700K 80CRI			
300WSAB						

Photometry

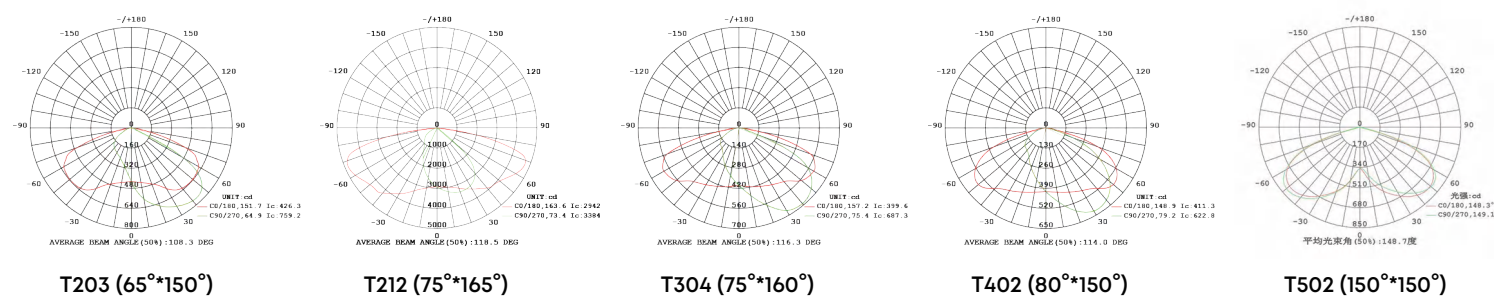

Illuminance Diagram

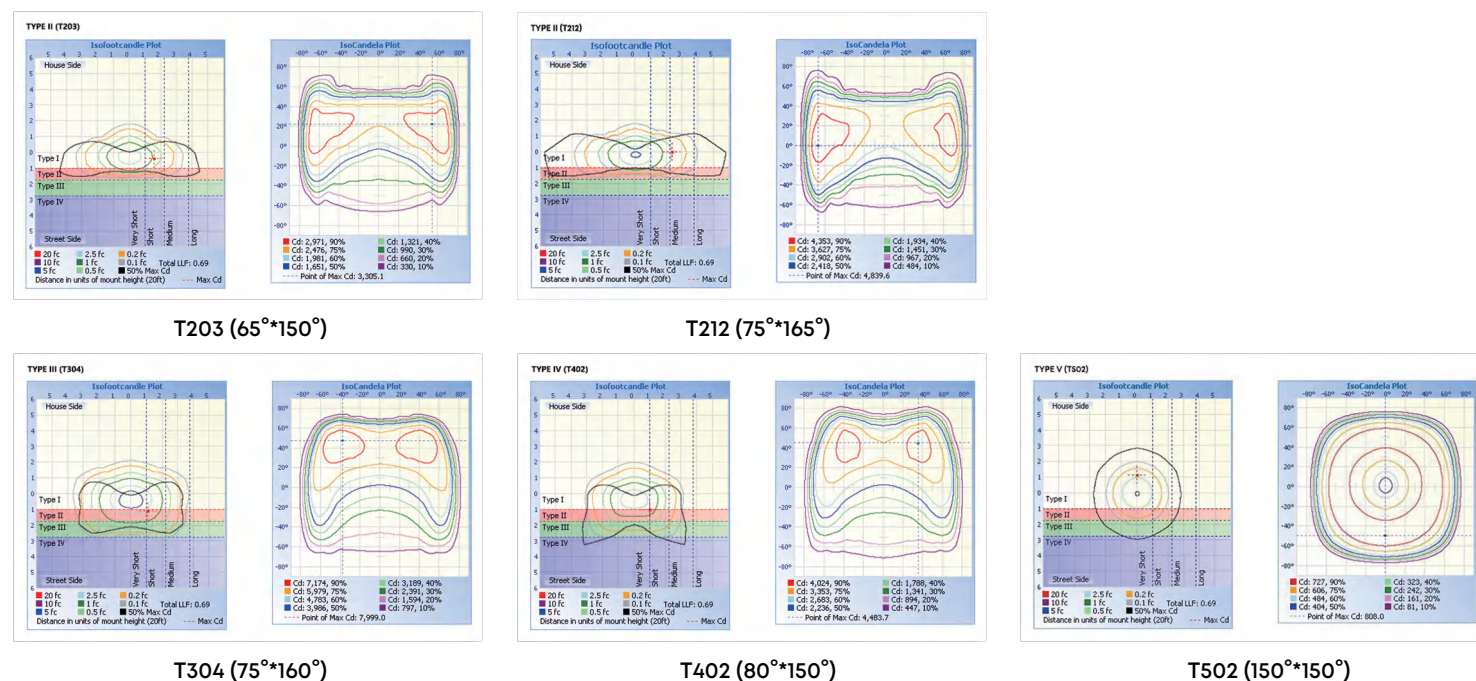

Dimensions

30W

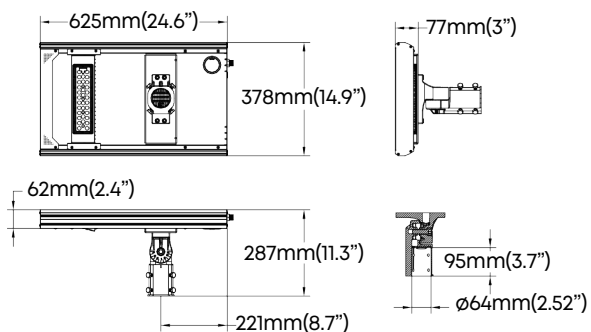

40W

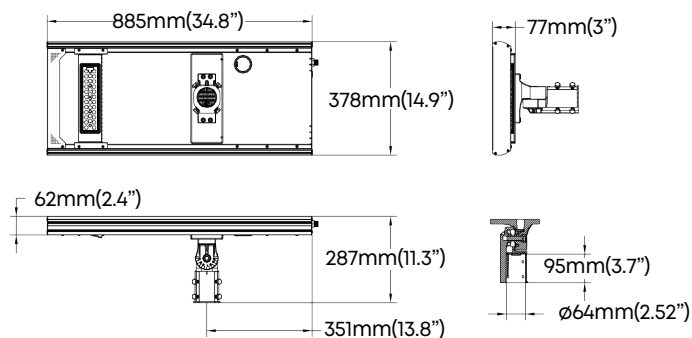

50W

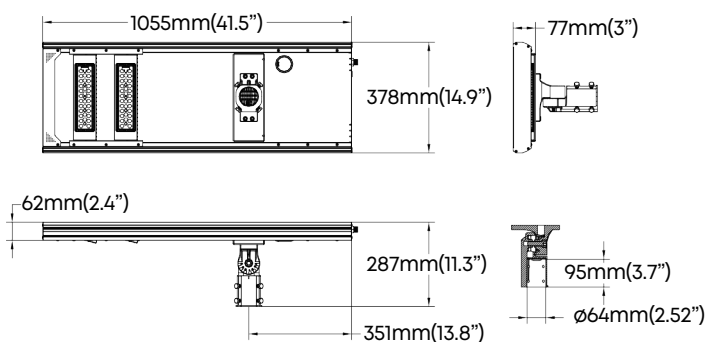

60W

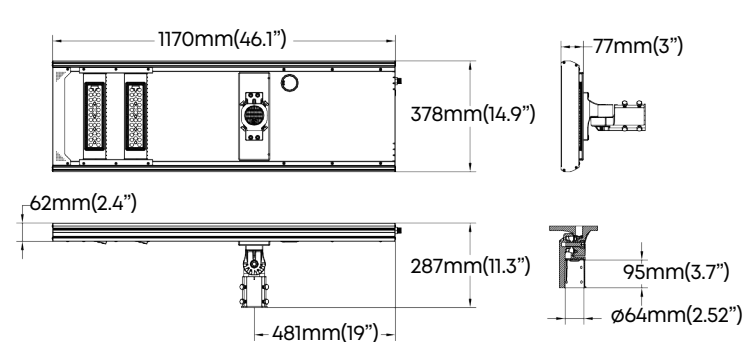

80W

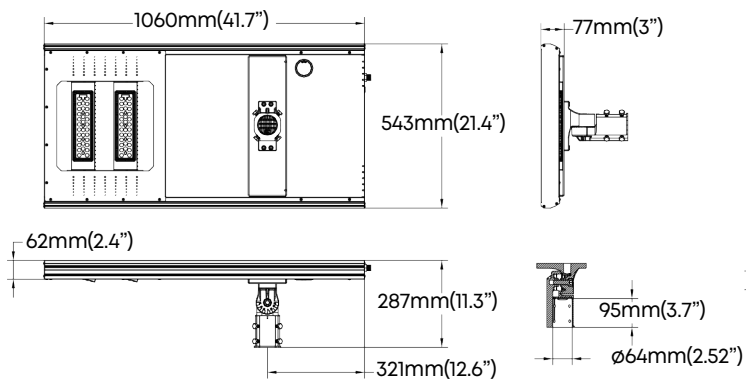

100W

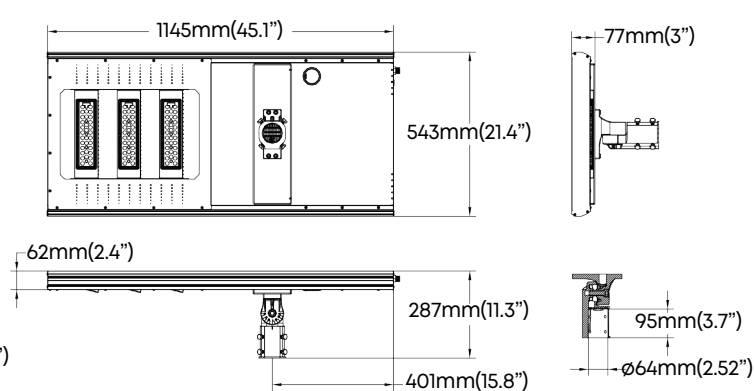

120W

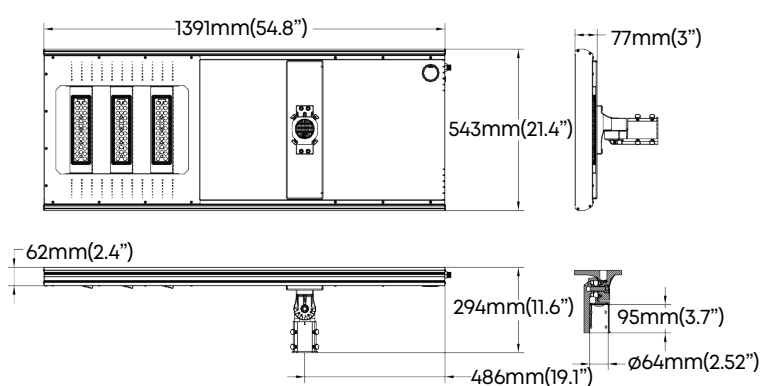

150W

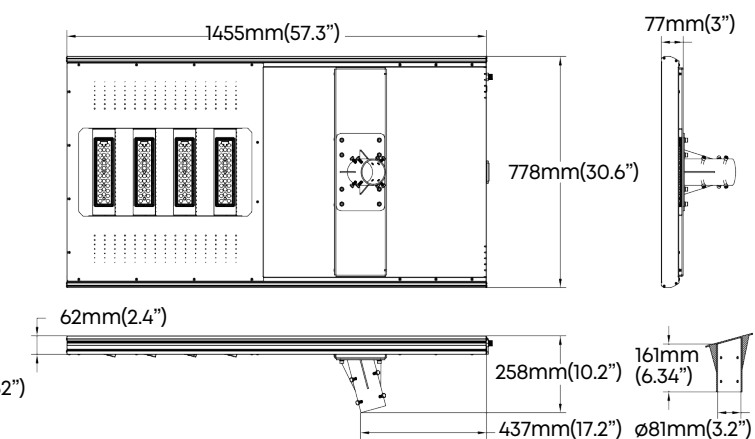

Dimensions

200W

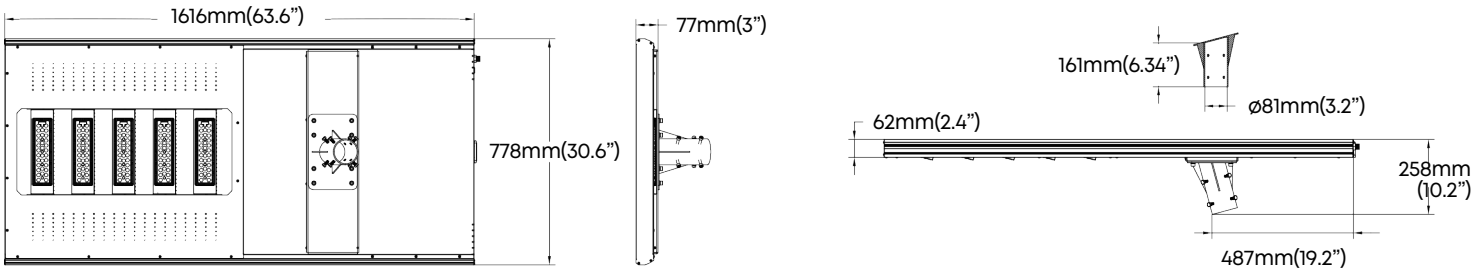

300W

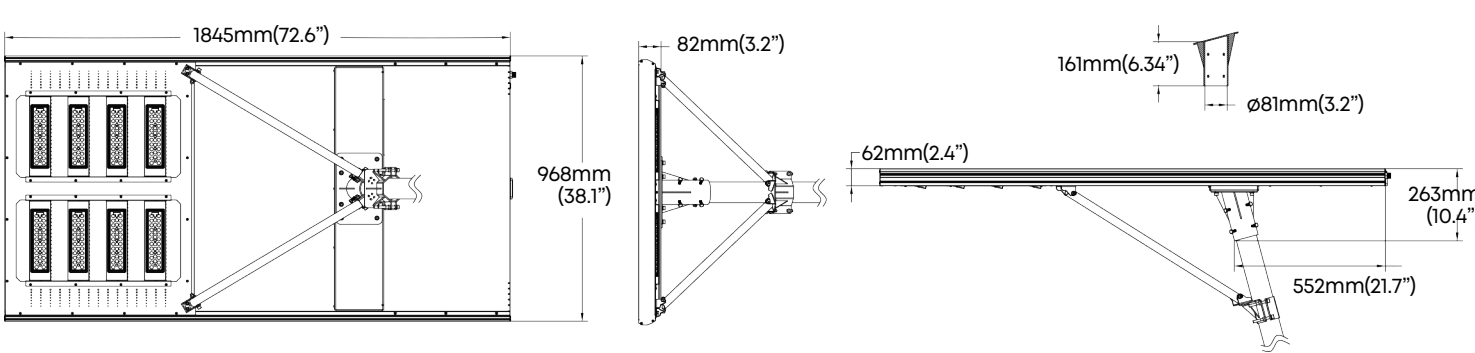

SCx (EPA)

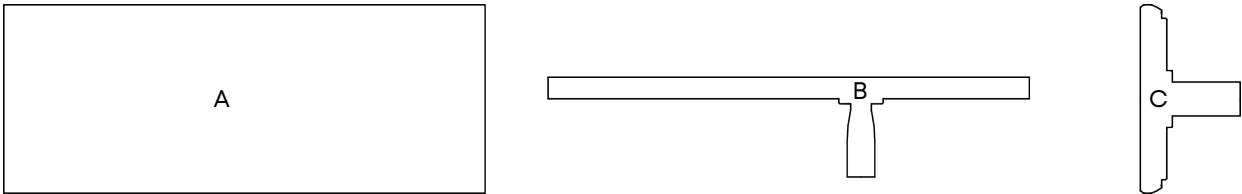

Power	30W	40W	50W	60W	80W	100W	120W	150W	200W	300W
A (Top View)	0.237m ² (2.55ft ²)	0.335m ² (3.61ft ²)	0.399m ² (4.29ft ²)	0.442m ² (4.76ft ²)	0.576m ² (6.2ft ²)	0.622m ² (6.7ft ²)	0.755m ² (8.13ft ²)	1.33m ² (14.32ft ²)	1.258m ² (13.54ft ²)	1.787m ² (19.24ft ²)
B (Side View)	0.057m ² (0.614ft ²)	0.074m ² (0.797ft ²)	0.084m ² (0.904ft ²)	0.091m ² (0.98ft ²)	0.085m ² (0.915ft ²)	0.09m ² (0.969ft ²)	0.107m ² (1.15ft ²)	0.113m ² (1.22ft ²)	0.123m ² (1.32ft ²)	0.139m ² (1.5ft ²)
C (Front View)	0.047m ² (0.506ft ²)	0.047m ² (0.506ft ²)	0.047m ² (0.506ft ²)	0.047m ² (0.506ft ²)	0.06m ² (0.646ft ²)	0.06m ² (0.646ft ²)	0.06m ² (0.646ft ²)	0.078m ² (0.84ft ²)	0.078m ² (0.84ft ²)	0.097m ² (1.04ft ²)



Innovative & Tailored Lighting Solutions for **Success**



wally@aokledlight.com
www.aokledlight.com
+1 626-986-4050 (US)
+86 755 2357 9148 (CN)

Manufacturing:

Shenzhen:

Building 1 & 4, St. George's Science and Technology Industrial Park, Shajing Street, Shenzhen, China, 518124.

Huizhou:

Building 2, Yinghui Electronic Science and Tech Park, No. 6 Dongsheng North Rd, Chenjiang Street, Zhongkai High-tech Zone, Huizhou, China. 516006.

Philippines:

Binan City, Laguna, Philippines.

Fuzhou Office:

Room 301, Yujing Business Center Zone 1, No. 12 Baihuazhou road, Cangshan district, Fuzhou, China, 350007

Copyright ©2025 AOK Industrial Company Limited. All Right Reserved.