

LED Street Light Installation Guide

- Before Installation

This procedure is designed as an installation aid. Skilled tradespeople that are familiar with general construction and electrical installation techniques should perform the installation. Licensed electricians should provide electrical installation connections. Installations and connections should be done in accordance with all national and local codes and permits. In no way is this document intended to construe warranty or fitness of use of the products described, nor is it intended to provide safety instruction for those installing the product.

WARNING

Before proceeding with installation or service maintenance of this product.

- Disconnect power to reduce electrical shock risk.
- Review the entire Installation Guide.
- Inspect this properly packaged product for any damage that may have occurred during transit.
- Verify product application complies with manufacturer design recommendations.
- Verify the availability of necessary tools and incidental material.
- Verify applicable code requirements. Field assembly and installation are subject to acceptance by local inspection authority.
- Appropriate safety equipment to be determined by end user, per applicable safety standards and precautions.

Installation Tools

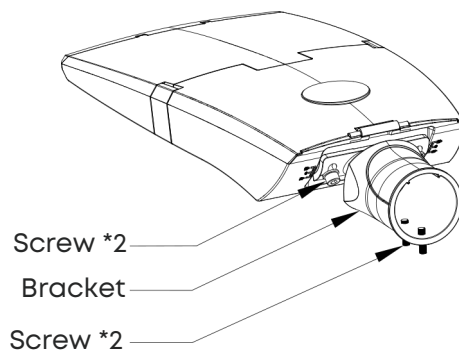
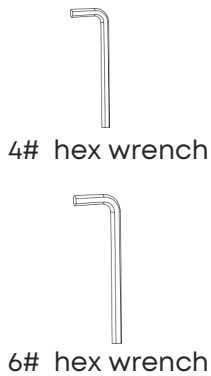

Suitable for light pole diameter

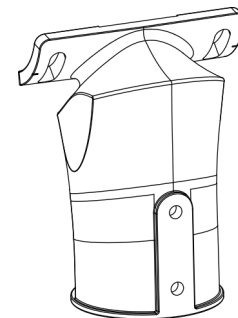

Ø42-60mm

If the fixture is installed by post top, please release the screws on the bracket behind the fixture and remove the bracket first, then turn the bracket in the opposite direction, use a 6# hex wrench to tighten the screws to fix the bracket, as shown below.

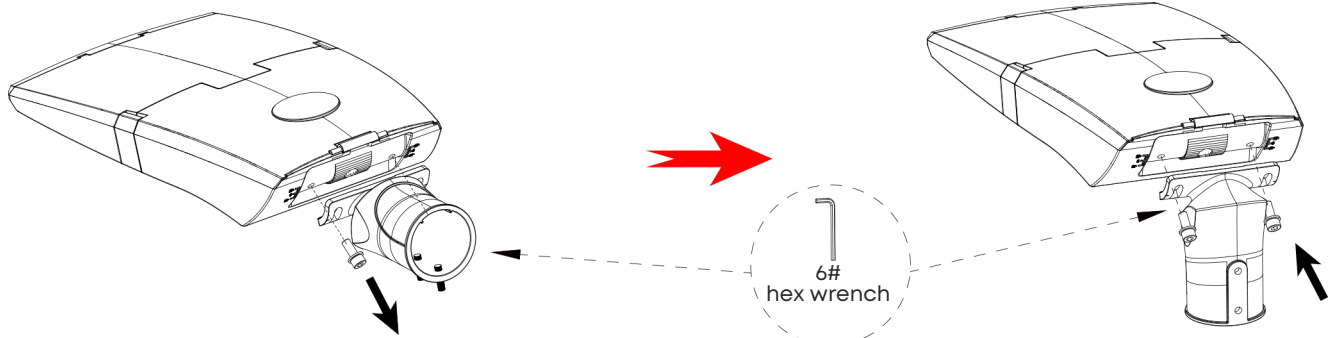

- Installation Steps

1. Loosen the 2 screws on the bracket without removing them.

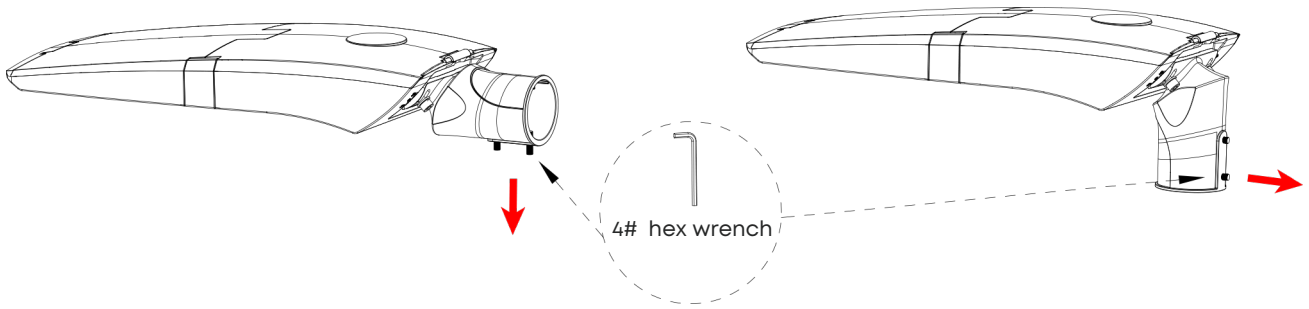

2. Connect the wires between the bracket of the fixture and the lamp pole (connect the L, and N, GND correspond to each) then insert the bracket into the lamp pole according to the arrow direction, as shown below.

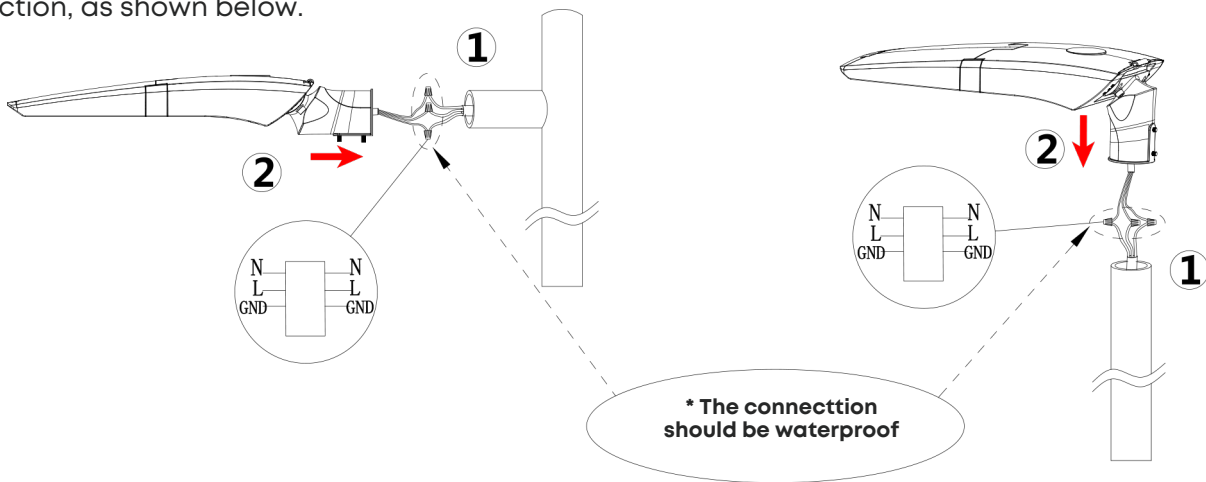
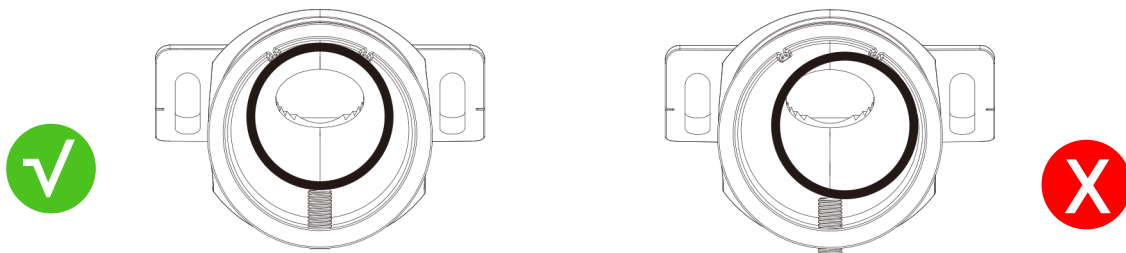
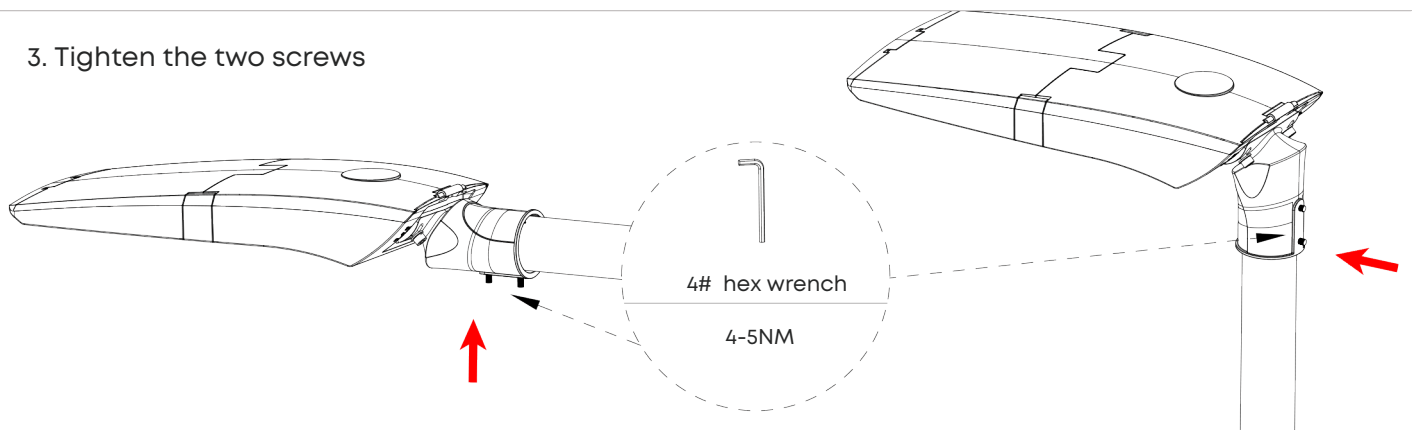

Diagram of correct and incorrect fixation of lamp pole and bracket.



3. Tighten the two screws



4. If the fixture's lateral angle needs to be adjusted, please loosen the two screws behind the fixture without removing them.

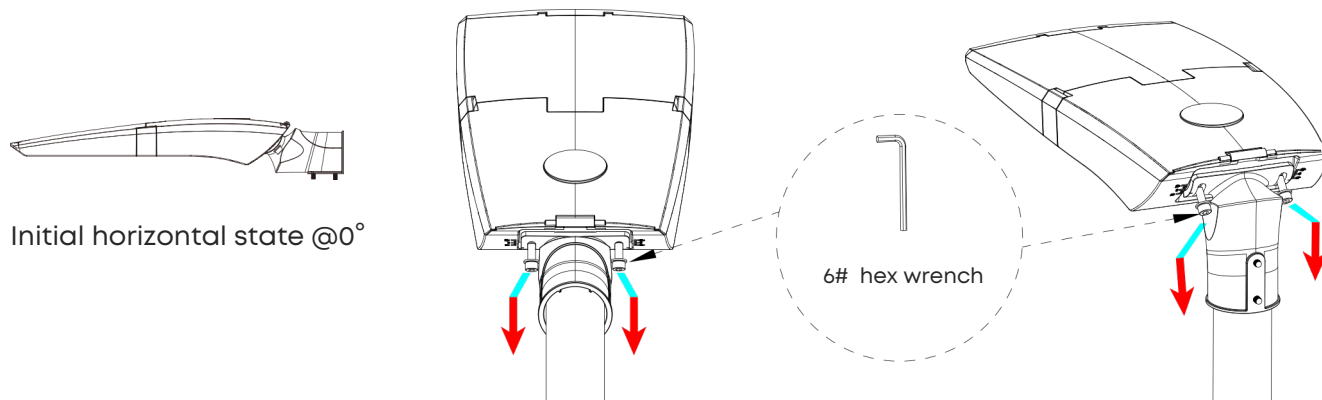

5. Rotate the fixture to the proper angle based on the actual requirement, then tighten two screws behind the fixture on the bracket.

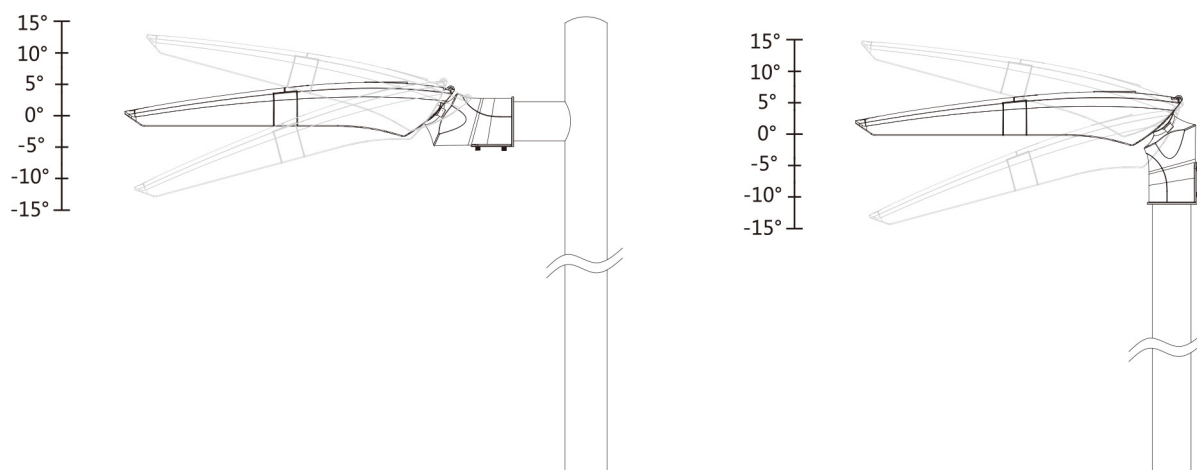

Scale Indication

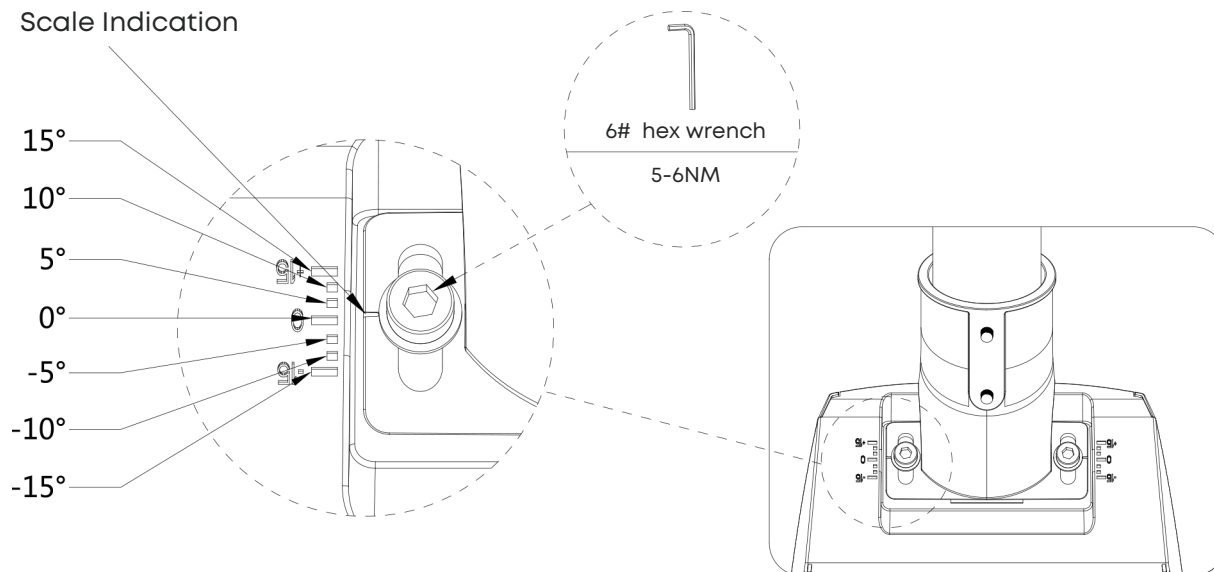

If it is necessary to replace accessories, follow the following steps for replacement. Note that a series of problems caused by improper human operation are not within the scope of after-sales service!

1. Replace the radiator and glass

(1) Release the buckle

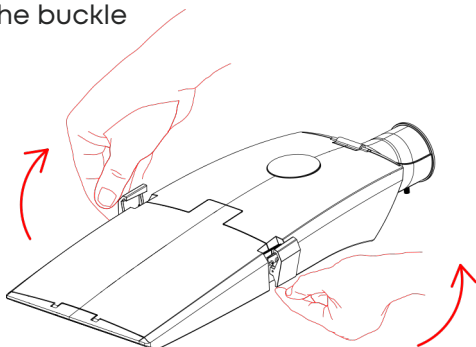

(2) Remove the radiator module

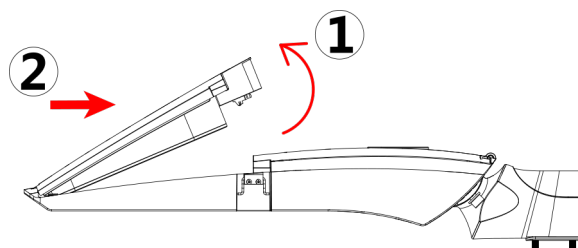

(3) Remove tempered glass

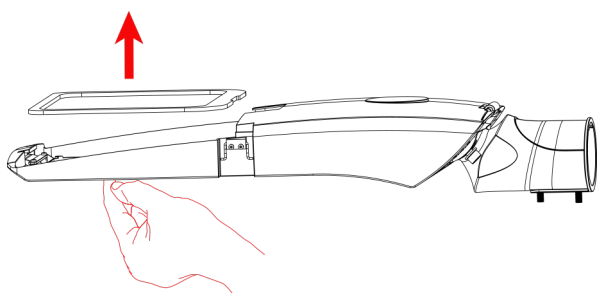

(4) Insert new tempered glass

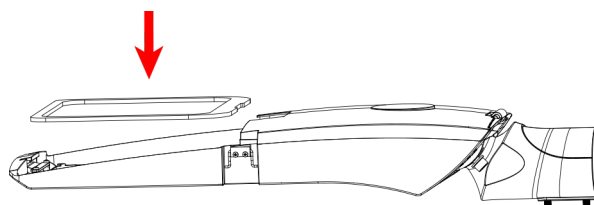

(5) Install a new radiator module

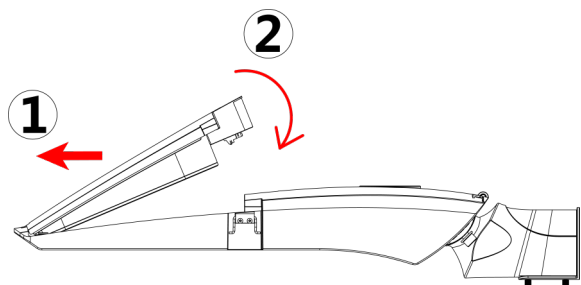

(6) Tighten the buckle

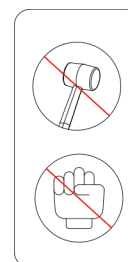
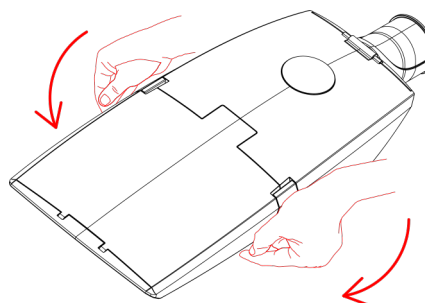

Press the clasp,
do not knock.

2. Replace the drive module separately

(1) Release the buckle

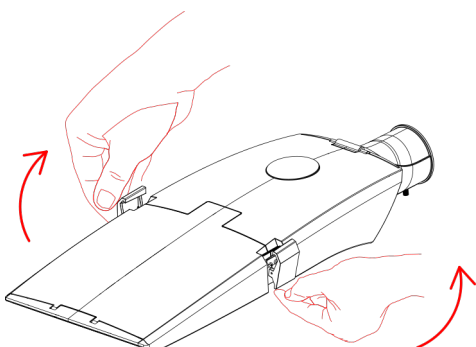

(2) Open the driver box cover

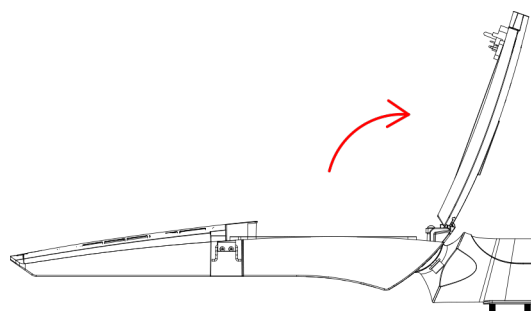

(3) Unplug the input and output power cables of the driver module

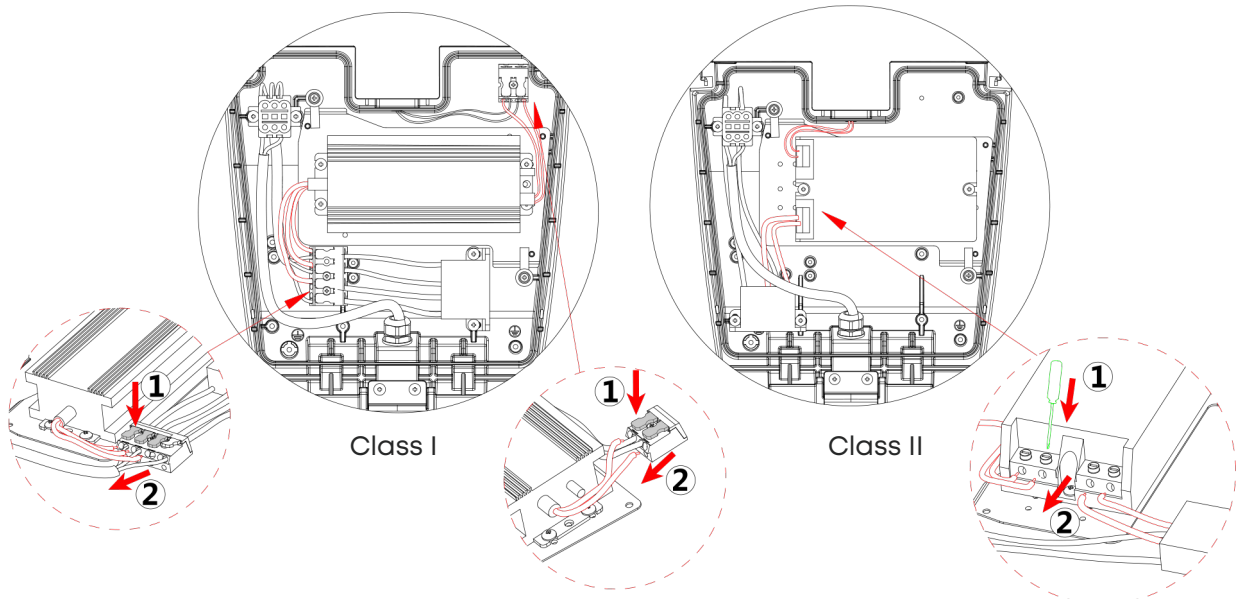

(4) Turn the knob counterclockwise

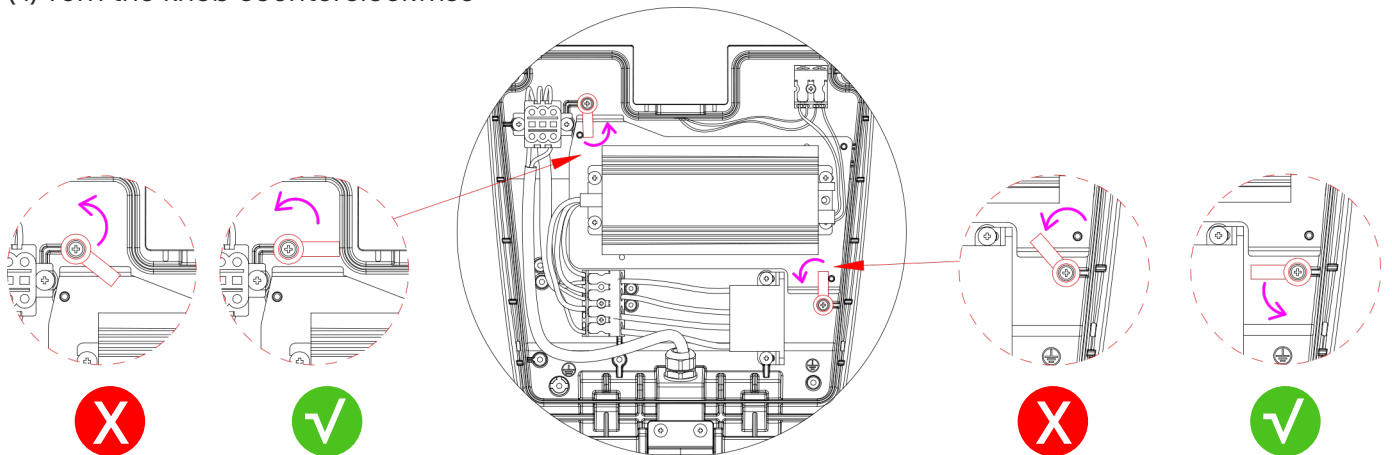

(5) Remove the driver module

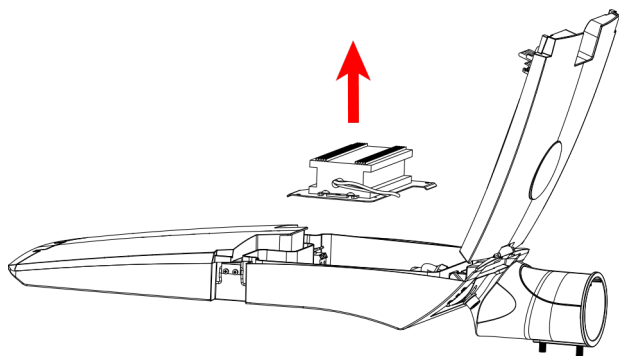

(6) Insert a new driver module

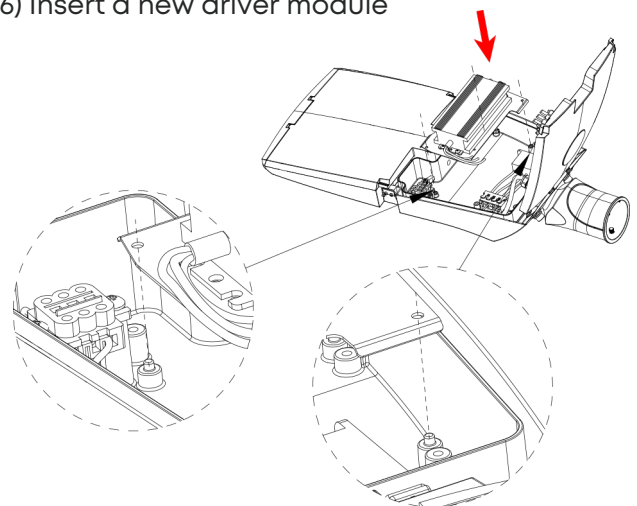

(7) Insert the input and output power lines of the drive module into the wiring terminals

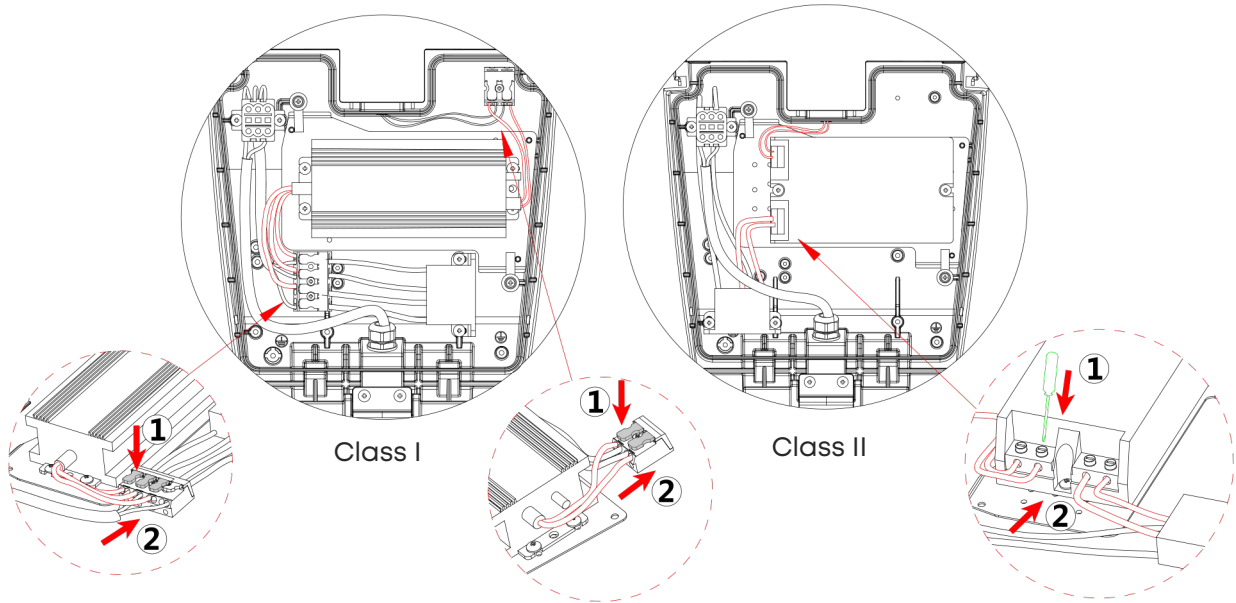

(8) Turn the knob clockwise

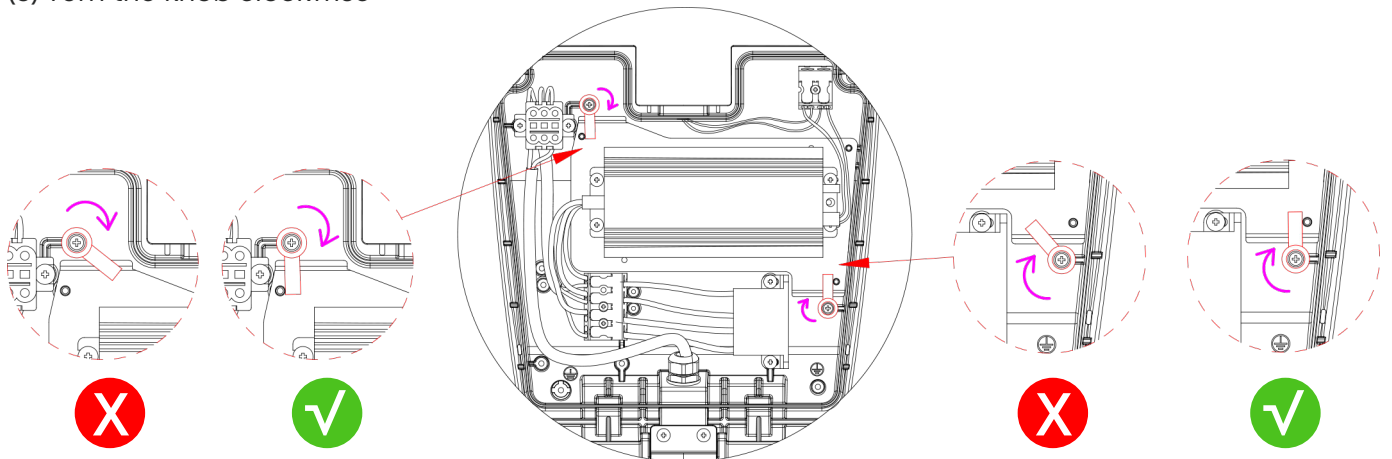

(9) Close the driver box cover

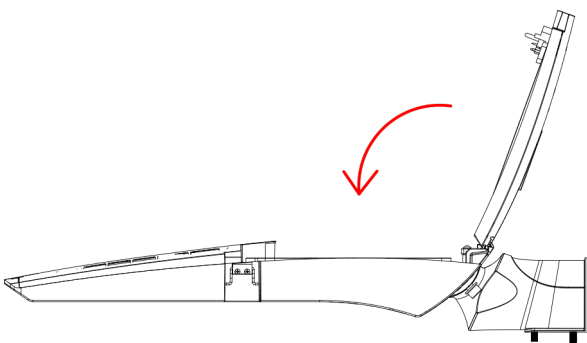

(10) Tighten the buckle

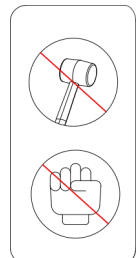
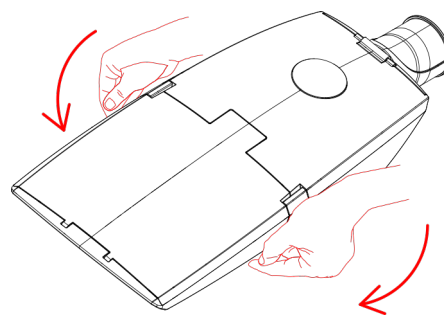

Press the clasp,
do not knock.