

IH SERIES

LED LINEAR HIGH BAY LIGHT

Power: 95W, 150W, 200W, 200W up to 600W replacement

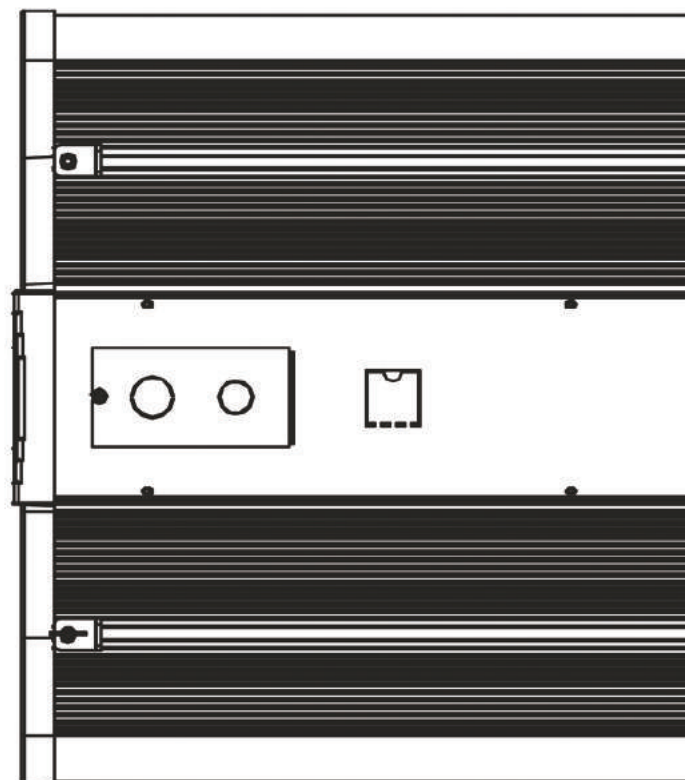

UP TO **130** LM/W

Overview

Specialized for indoor high bay lighting with excellent evenness;
 Suitable for factory, warehouse, supermarket, school, etc;
 Super slim design with gorgeous looking;
 Highly upgradeable for motion sensor, PIR sensor, smart sensor, etc;
 System efficacy 130lm/w, lifespan >50000 hours;
 Support multiple installation methods.



Installation Methods

Chain /
 Cable Mount
 (Standard)

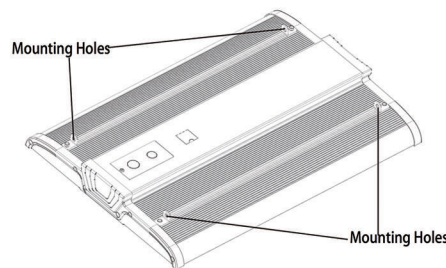

Chain/cable mount is standard and included in price. Price adder for Y-cable, Rod Mount, and Pendant Mount. Please consult sales for latest information and see "Installation Instructions" for mounting details.

Rod Mount
 (Optional)

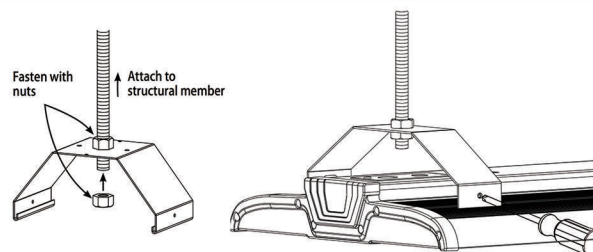

Surface Mount (Optional)

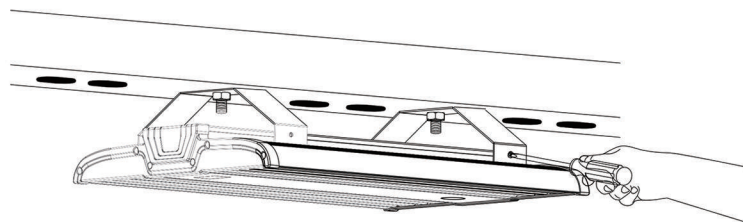

Pendant Mount
 (Optional)

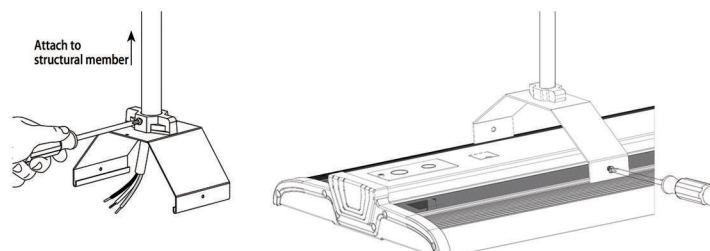

Y-Cable w/hook
 (Optional)



AOK iH Series

LED Linear High Bay Light



This product is UL/cUL, DLC, FCC, SAA, CE and RoHS certified



Model	AOK-95WiH	AOK-150WiH	AOK-200WiH
Nominal Wattage	95W	150W	200W
Replacement	250W	400W	600W
Maxium Current	1.05A	1.65A	2.20A
Input Voltage	100-277VAC / 347VAC / 480VAC		
Dimming	1-10V		
Accessories	Built-in occupancy sensor available		
Working Temperature	-40 F ~122 F		
Power Factor (PF)	>0.95		
THD	<15%		
Lumen Output (+/- 5%)	13432lm @99.58W, 5700K	20202lm @152.5W, 5700K	26326lm @198.6W, 5700K
System Efficacy	134.89lm/w @5700K	132.47lm/w @5700K	132.56lm/w @5700K
Optical Lens	120° frosted		
CRI	Ra>70 / Ra>80		
CCT	3000-6500K		
IP&IK Rating	IP40 & IK08		
Materia	Die-cast alumium		
Housing Color Options	White		
Lifespan	>50000 hours @L70		
Fixture Dimensions	24*16.5*2.8" (61*42*7cm)		
Net Weight	10 lbs (4.5kg)		
Carton Dimensions	25.6*18*4.7" (65*46*12cm)		
Gross Weight	13 lbs (5.8kg)	19.8 lbs (9kg)	15.4 lbs (7kg)
Packing	1 Pcs per carton		